

Soils Map

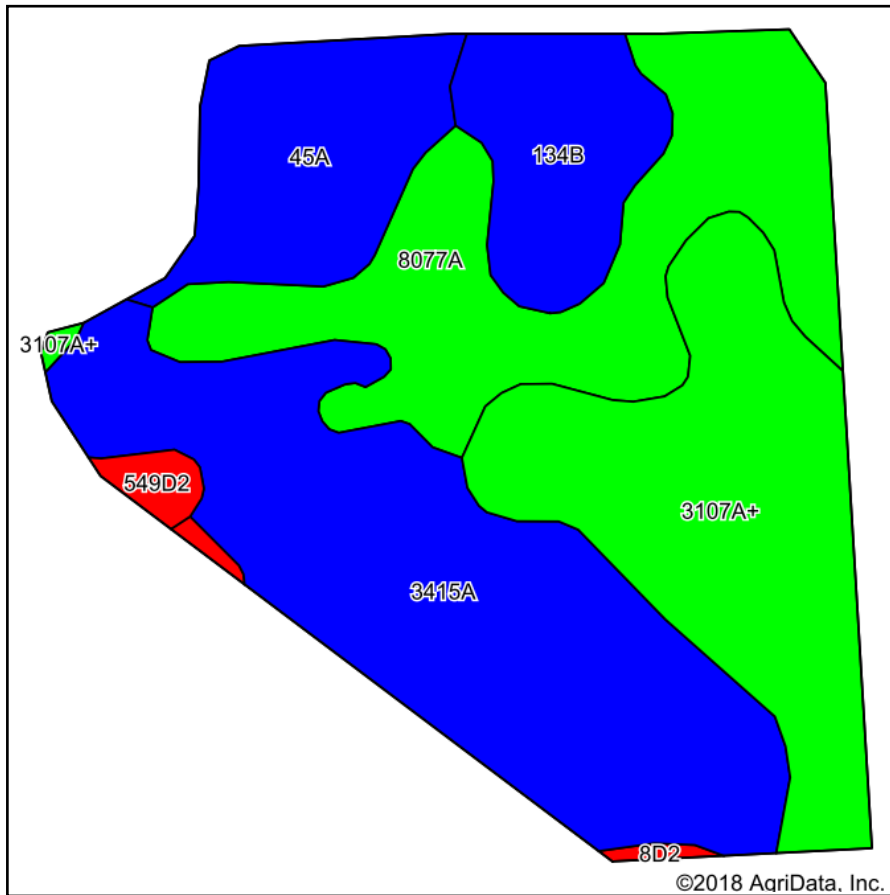

Soils data provided by USDA and NRCS.

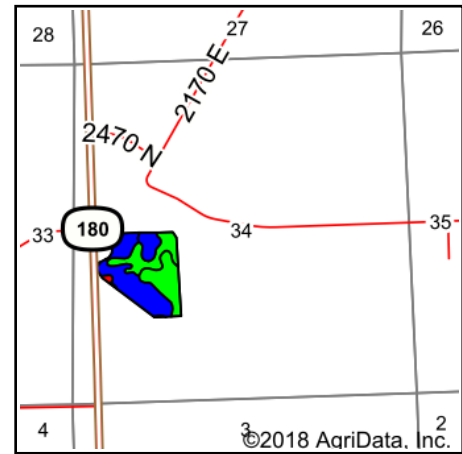

State: **Illinois**
 County: **Knox**
 Location: **34-13N-4E**
 Township: **Lynn**
 Acres: **28.1**
 Date: **9/20/2018**

John Leezer, ALC
 (309) 286-2221
www.illinoisfarms4sale.com

Maps Provided By:

 CUSTOMIZED ONLINE MAPPING
 © AgriData, Inc. 2018 www.AgriDataInc.com



Area Symbol: IL095, Soil Area Version: 12

Code	Soil Description	Acres	Percent of field	Il. State Productivity Index Legend	Corn Bu/A	Soybeans Bu/A	Crop productivity index for optimum management
3415A	Orion silt loam, 0 to 2 percent slopes, frequently flooded	9.19	32.7%		180	57	131
3107A+	Sawmill silt loam, 0 to 2 percent slopes, frequently flooded, overwash	6.64	23.6%		189	60	139
8077A	Huntsville silt loam, 0 to 2 percent slopes, occasionally flooded	6.29	22.4%		193	61	143
45A	Denny silt loam, 0 to 2 percent slopes	3.09	11.0%		159	52	118
**134B	Camden silt loam, 2 to 5 percent slopes	2.43	8.6%		**164	**50	**118
**549D2	Marseilles silt loam, 10 to 18 percent slopes, eroded	0.30	1.1%		**121	**39	**90
**8D2	Hickory silt loam, 10 to 18 percent slopes, eroded	0.16	0.6%		**108	**36	**82
Weighted Average					180.3	57.1	132.3

Table: Optimum Crop Productivity Ratings for Illinois Soil by K.R. Olson and J.M. Lang, Office of Research, ACES, University of Illinois at Champaign-Urbana. Version: 1/2/2012 Amended Table S2 B811

Crop yields and productivity indices for optimum management (B811) are maintained at the following NRES web site: <http://soilproductivity.nres.illinois.edu/>

** Indexes adjusted for slope and erosion according to Bulletin 811 Table S3

Soils data provided by USDA and NRCS. Soils data provided by University of Illinois at Champaign-Urbana.

*c: Using Capabilities Class Dominant Condition Aggregation Method